

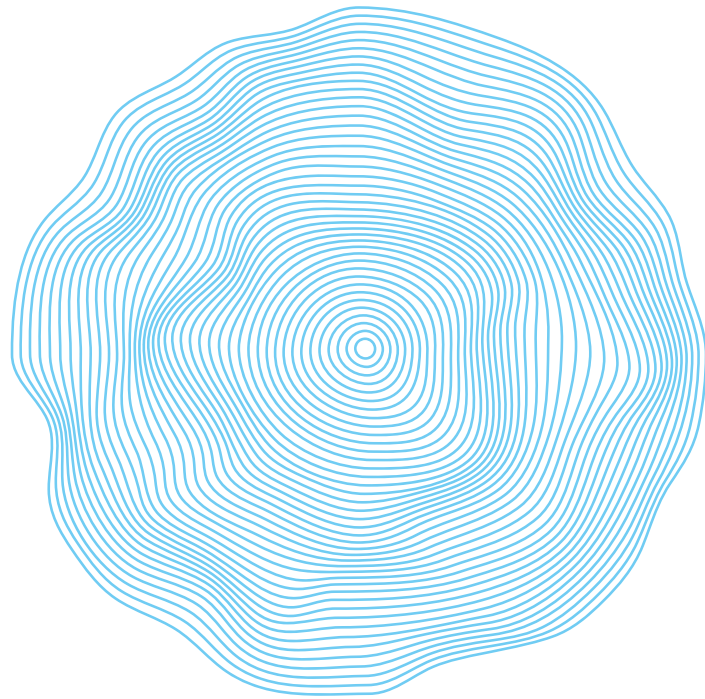

SOBHA HARTLAND



## Where Escaping is staying

Enjoy the perks of living by a crystal lagoon in central Dubai



Why make Sobha Hartland  
your home?

Views of Ras Al Khor Wildlife Sanctuary and the crystal lagoon.

Located in the epicentre of the city with major landmarks just minutes away.

2 International schools within the Sobha Hartland Community.

3 lush green parks connected by a central pathway for all residents.

**Central Park**

Acres of green canopies surround you in this exclusive park in Hartland Estates.

**Greens East Park**

A park designed for outdoor recreation with an amphitheater, kids' play area, rock-climbing wall and a lot more.

**Greens West Park**

Bringing the forest to your doorstep in this park that is a doorway to a world far away, yet in the centre of the city.

INTRODUCING

THE

CREST

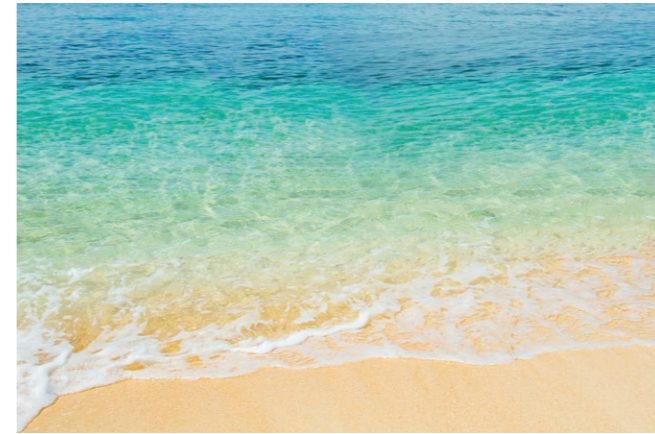

Caribbean-style crystal lagoon facing residences  
*now have a name*

THE  
CREST



Residential towers with inter-linked Sky Gardens  
*now have a name*

THE  
CREST



Experiential community living  
*now has a name*

THE  
CREST



## What does The Crest at Sobha Hartland have to offer

- Located on the banks of a pristine **CRYSTAL LAGOON**.  
3 inter-connected expansive towers.

- **LIMITED RELEASE**

The Crest Tower A has residences spread across 46 floors.

The 3 towers have a series of stepped **SKY GARDENS** connecting them with each other.

- A host of **AMENITIES** spread across the podium level and the landscaped terraces; curated just for you.
- Residential living space that provides endless moments of **EXPERIENCES**.
- Inter-linked **SKYWALK** that brings all 3 towers of The Crest together.

THE  
CREST





THE BOOK OF AMENITIES

THE CREST



A lifestyle worthy of your every day,  
*with no reason to step out.*



\*Images used for representative purpose only

INDOOR

THE  
CREST



Health Club with  
changing rooms

THE  
CREST

Multipurpose Hall





Spin Class Studio

THE  
CREST

Pilates Studio





Yoga Studio

OUTDOOR

THE  
CREST



Swimming Pool

THE  
CREST

Kids Play Area





Barbeque Area

THE  
CREST

Pentanque Boules Lawn





Outdoor Gym Terrace

THE  
CREST

Tai Che Terrace







THE  
CREST

Landscaped Terraces at different levels with a host of amenities

Inter-linked Sky Gardens at different levels





## Payment Plan

1, 2 & 3 bedroom apartments starting from

**AED 1.1 Mn\***

<b>5 year</b>	<b>70%</b>	<b>30%</b>
Payment plan*	Over 4 years	On completion in 2025

THE  
**CREST**

\*Images used for representative purpose only

\*T&C apply

MASTER PLAN

FLOOR PLANS

RESIDENTIAL UNIT PLANS

THE  
CREST

# LOCATION IN THE MASTER PLAN

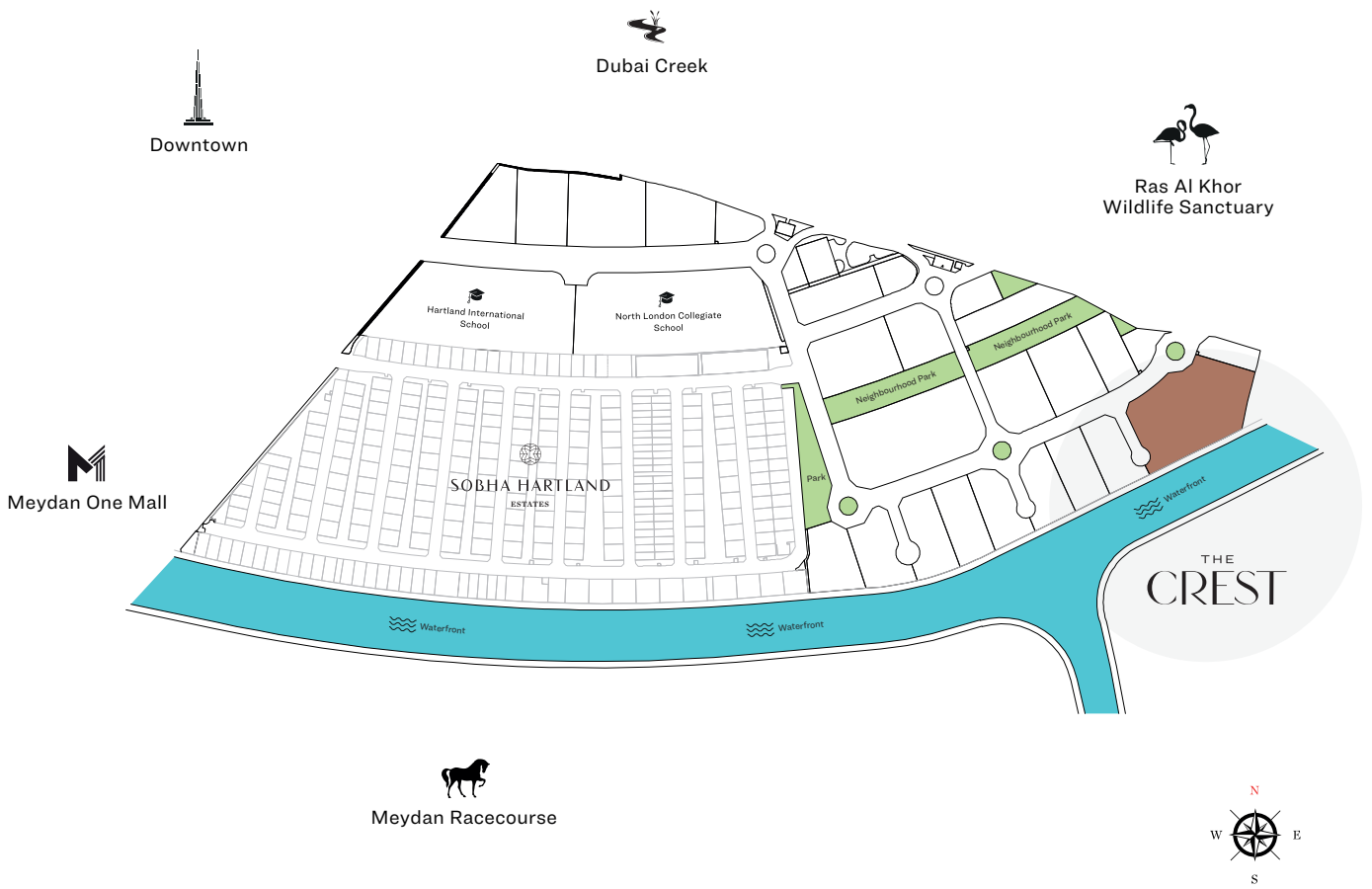

## APARTMENT FEATURES



Landmark views



Covered car parking



Fully fitted kitchens



Bedroom wardrobe in all units

# FLOOR PLAN LAYOUT

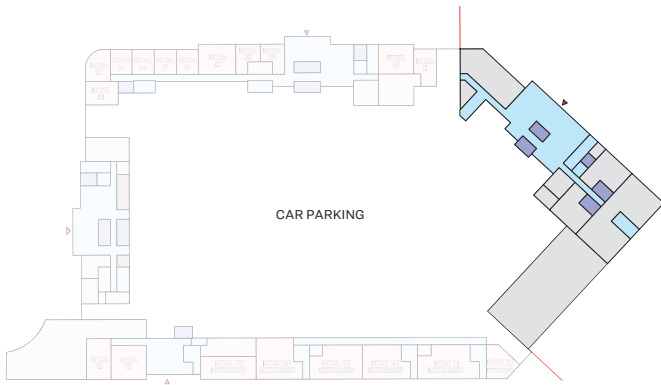
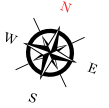

GROUND LEVEL

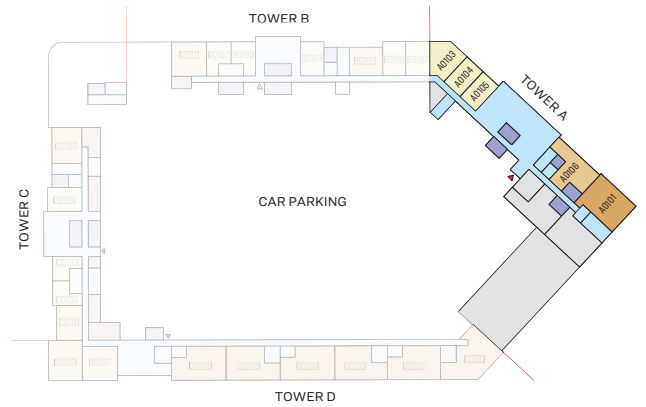

LEVEL-01(PODIUM 01)

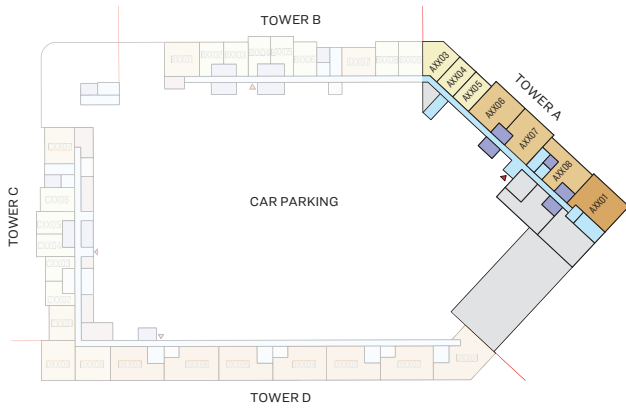

LEVEL-02,03 (PODIUM 02,03) TYPICAL FLOOR PLAN

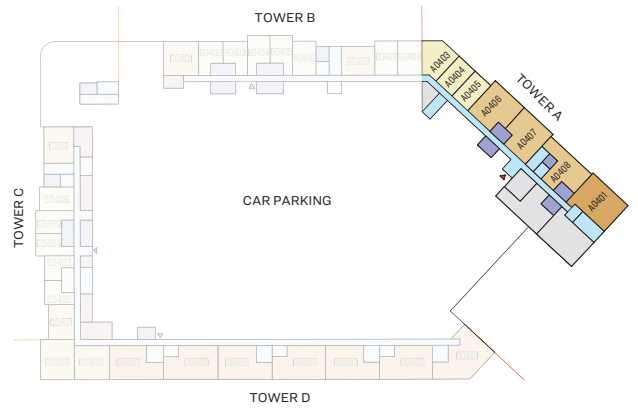

LEVEL-04(PODIUM 04)

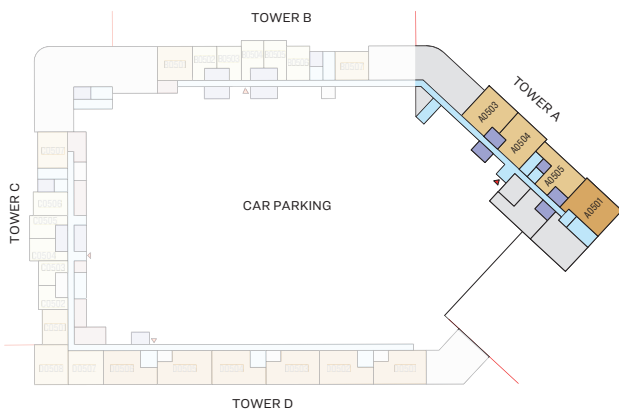

LEVEL-05(PODIUM 05)

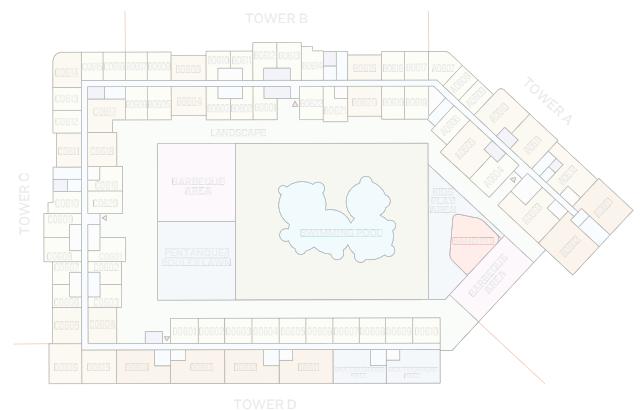

LEVEL-06

- |  |   |   |  |
|--|---|---|--|
| <span style="display: inline-block; width: 15px; height: 15px; background-color: #f0e68c; border: 1px solid black;"></span> 1 BED UNIT                 | <span style="display: inline-block; width: 15px; height: 15px; background-color: #a9a9a9; border: 1px solid black;"></span> SERVICES        | <span style="display: inline-block; width: 15px; height: 15px; background-color: #f08080; border: 1px solid black;"></span> COMMERCIAL    | <span style="display: inline-block; width: 15px; height: 15px; background-color: #d8bfd8; border: 1px solid black;"></span> BARBEQUE AREA      |
| <span style="display: inline-block; width: 15px; height: 15px; background-color: #d2691e; border: 1px solid black;"></span> 2 BED UNIT                 | <span style="display: inline-block; width: 15px; height: 15px; background-color: #4169e1; border: 1px solid black;"></span> LIFT            | <span style="display: inline-block; width: 15px; height: 15px; background-color: #90ee90; border: 1px solid black;"></span> LANDSCAPE     | <span style="display: inline-block; width: 15px; height: 15px; background-color: #808000; border: 1px solid black;"></span> SWIMMING POOL DECK |
| <span style="display: inline-block; width: 15px; height: 15px; background-color: #cd853f; border: 1px solid black;"></span> 3 BED UNIT                 | <span style="display: inline-block; width: 15px; height: 15px; background-color: #4682b4; border: 1px solid black;"></span> AMENITIES       | <span style="display: inline-block; width: 15px; height: 15px; background-color: #00bfff; border: 1px solid black;"></span> SWIMMING POOL |  |
| <span style="display: inline-block; width: 15px; height: 15px; background-color: #6495ed; border: 1px solid black;"></span> LOBBIES,CORRIDORS & STAIRS | <span style="display: inline-block; width: 15px; height: 15px; background-color: #a52a2a; border: 1px solid black;"></span> APARTMENT STORE | <span style="display: inline-block; width: 15px; height: 15px; background-color: #ff0000; border: 1px solid black;"></span> SAND PIT      |  |

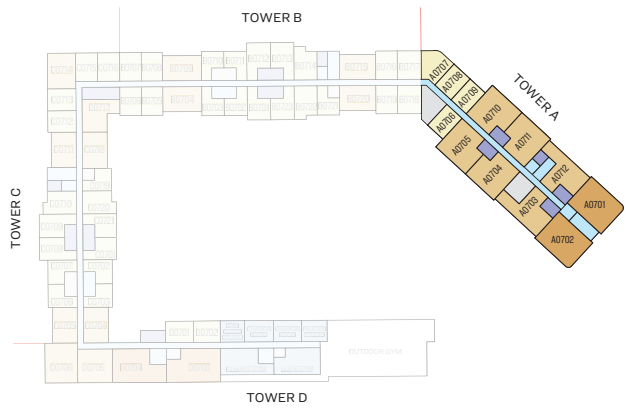
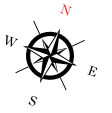

LEVEL-07

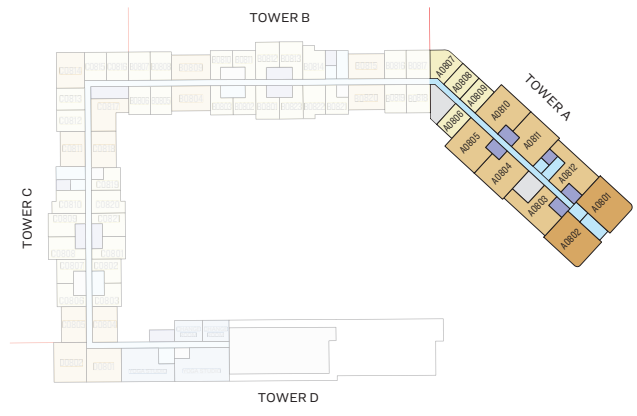

LEVEL-08

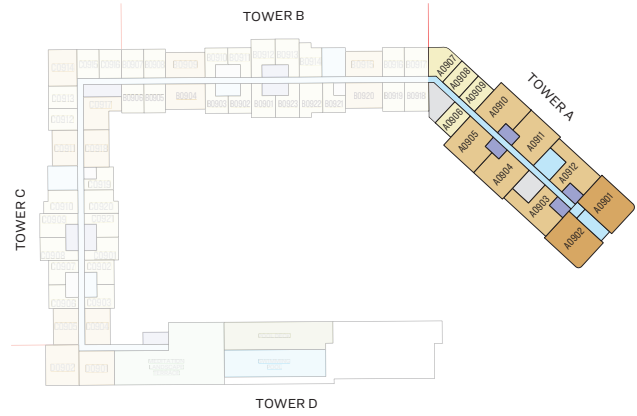

LEVEL-09

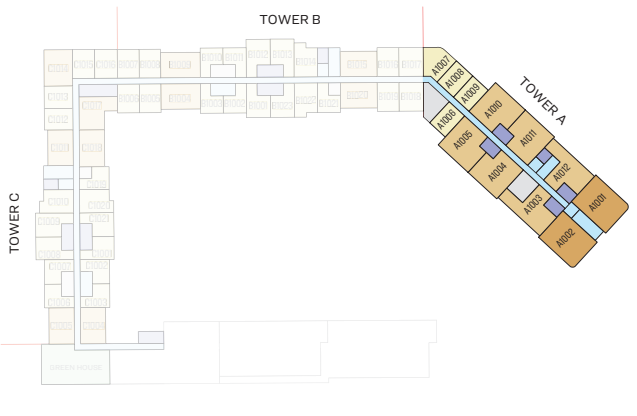

LEVEL 10

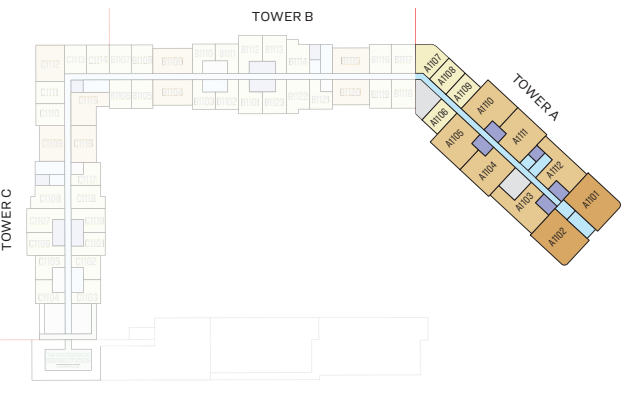

LEVEL 11

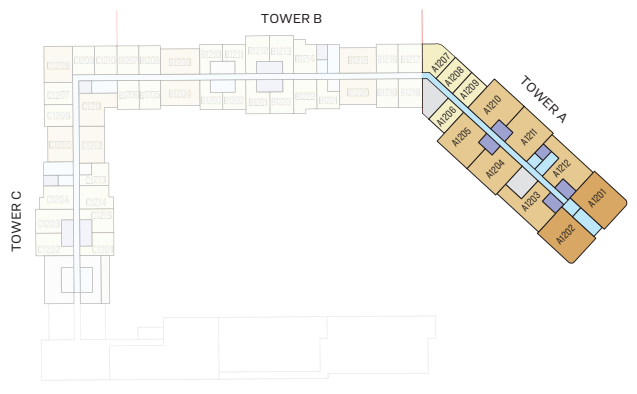

LEVEL 12

- |   |  |   |
|---|--|---|
| <span style="display:inline-block; width:15px; height:15px; background-color:#f0e68c; border:1px solid black;"></span> 1 BED UNIT                 | <span style="display:inline-block; width:15px; height:15px; background-color:#a9a9a9; border:1px solid black;"></span> SERVICES  | <span style="display:inline-block; width:15px; height:15px; background-color:#00a0e3; border:1px solid black;"></span> SWIMMING POOL      |
| <span style="display:inline-block; width:15px; height:15px; background-color:#c47a3b; border:1px solid black;"></span> 2 BED UNIT                 | <span style="display:inline-block; width:15px; height:15px; background-color:#4b4b9b; border:1px solid black;"></span> LIFT      | <span style="display:inline-block; width:15px; height:15px; background-color:#6b8e23; border:1px solid black;"></span> SWIMMING POOL DECK |
| <span style="display:inline-block; width:15px; height:15px; background-color:#8b4513; border:1px solid black;"></span> 3 BED UNIT                 | <span style="display:inline-block; width:15px; height:15px; background-color:#4b699b; border:1px solid black;"></span> AMENITIES |   |
| <span style="display:inline-block; width:15px; height:15px; background-color:#00a0e3; border:1px solid black;"></span> LOBBIES,CORRIDORS & STAIRS | <span style="display:inline-block; width:15px; height:15px; background-color:#8bc34a; border:1px solid black;"></span> LANDSCAPE |   |

Disclaimer: 1. Information is subject to change without notice, at developer's absolute discretion. 2. Drawings are not to scale. 3. All images used are for illustrative purpose only and do not represent the actual size, features, specifications 4. The developer reserves the right to make revisions/ alterations, at its absolute discretion, without any liability whatsoever.

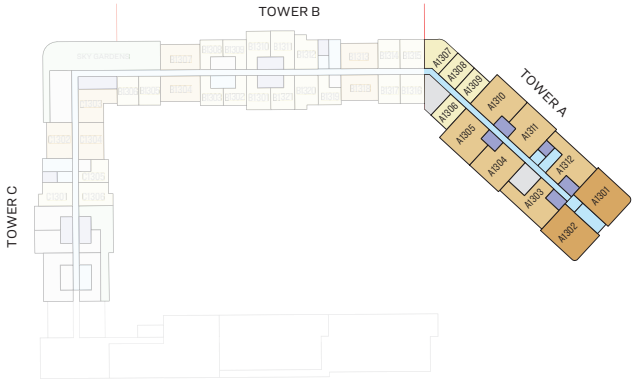
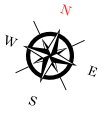

LEVEL 13

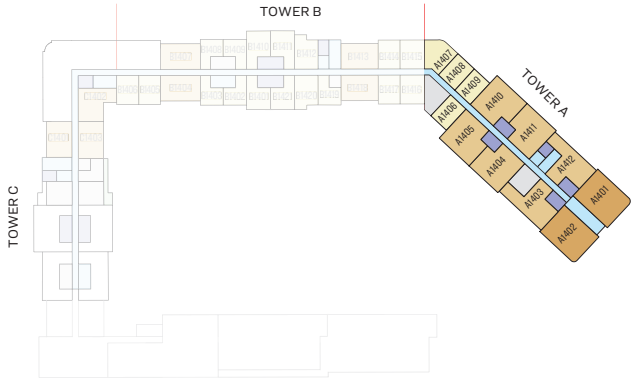

LEVEL 14

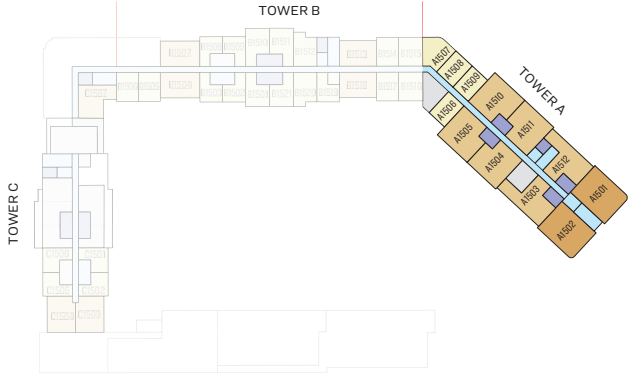

LEVEL 15

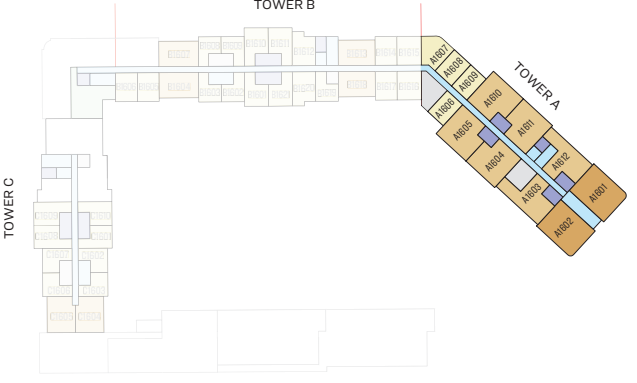

LEVEL 16

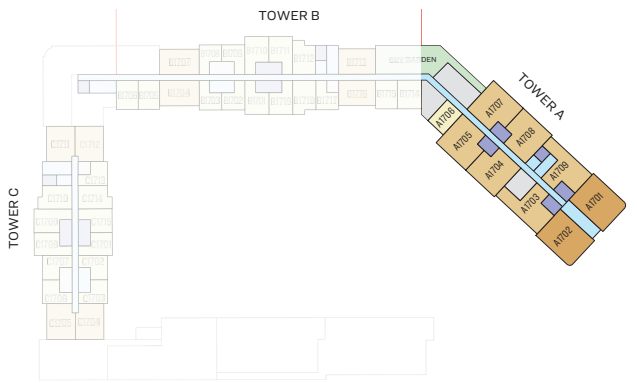

LEVEL 17

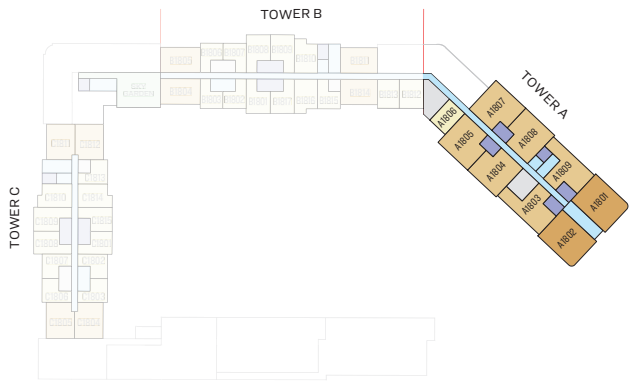

LEVEL 18

- 1 BED UNIT
- 2 BED UNIT
- 3 BED UNIT
- LOBBIES, CORRIDORS & STAIRS
- SERVICES
- LIFT
- AMENITIES
- LANDSCAPE

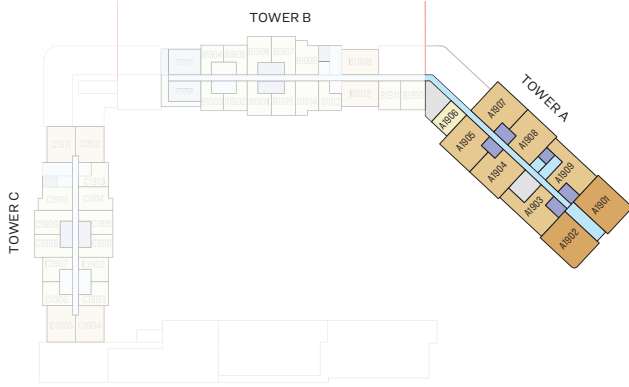
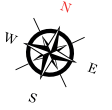

LEVEL 19

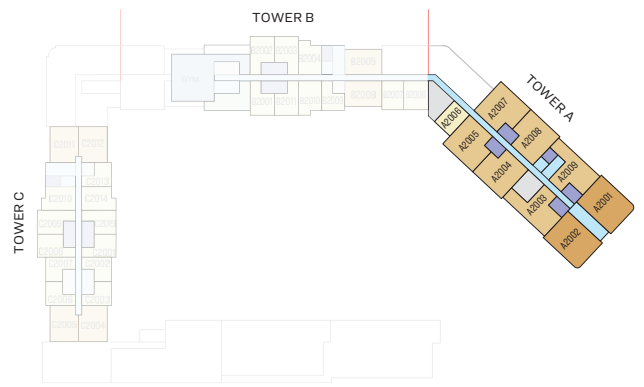

LEVEL 20

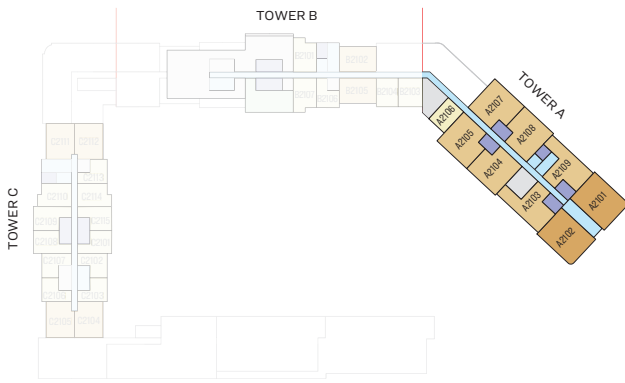

LEVEL 21

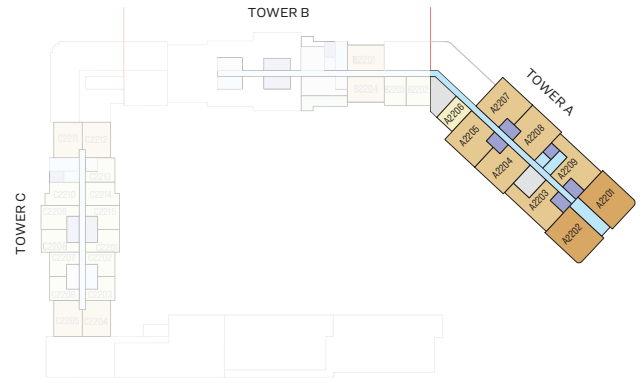

LEVEL 22

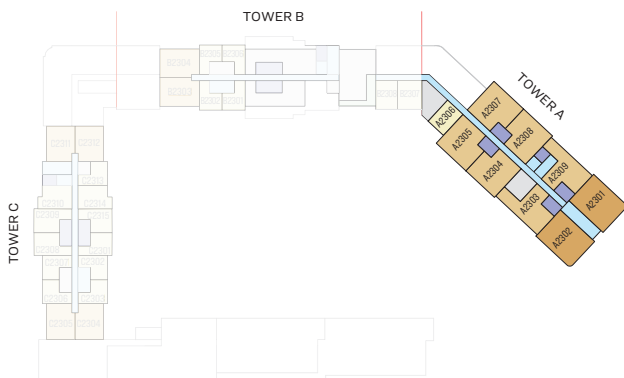

LEVEL 23

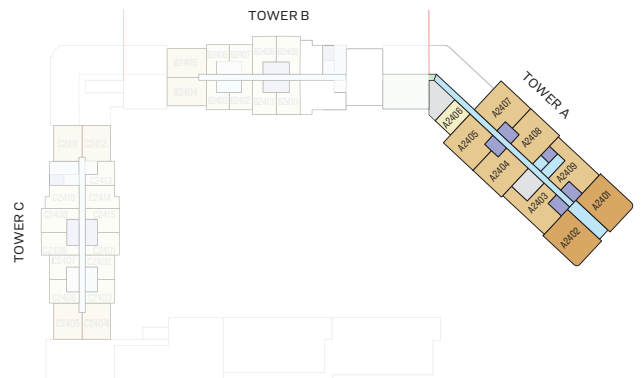

LEVEL 24

- |                             |           |
|-----------------------------|-----------|
| 1 BED UNIT                  | SERVICES  |
| 2 BED UNIT                  | LIFT      |
| 3 BED UNIT                  | AMENITIES |
| LOBBIES, CORRIDORS & STAIRS | LANDSCAPE |



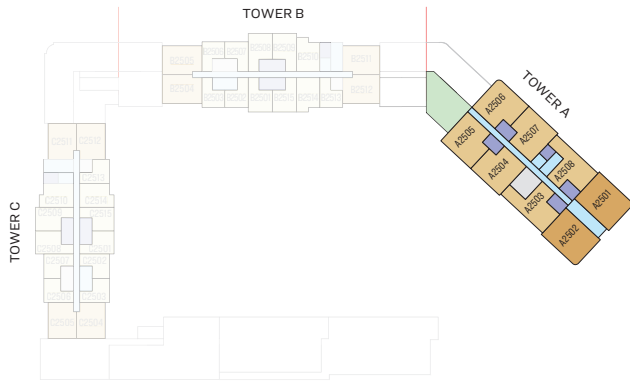
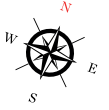

LEVEL 25

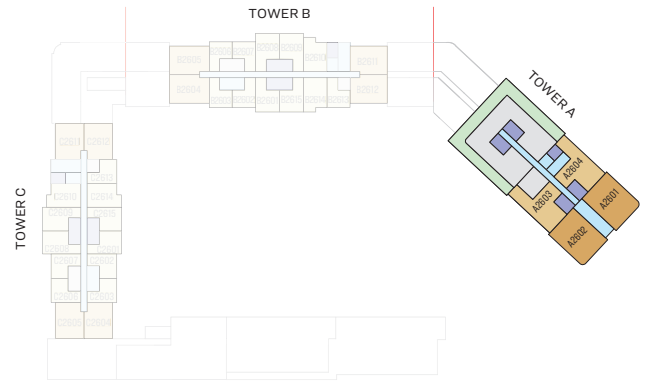

LEVEL 26

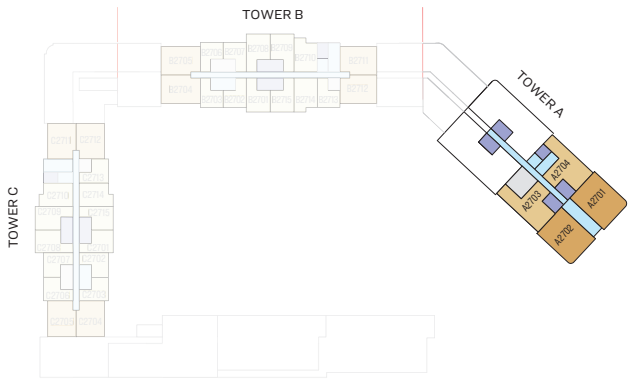

LEVEL 27

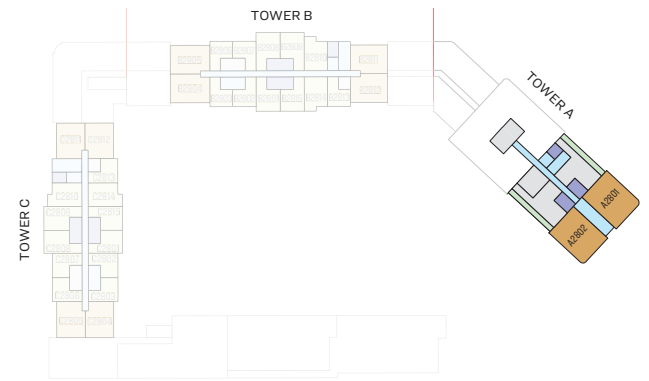

LEVEL 28

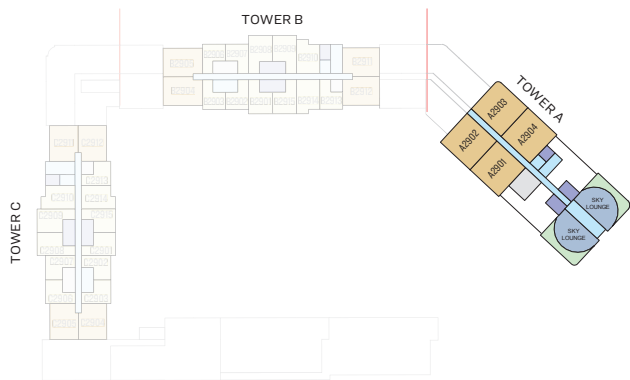

LEVEL 29

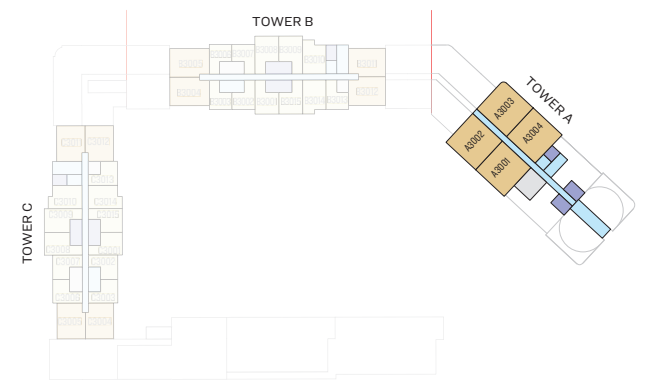

LEVEL 30

- |  |  |
|--|--|
| <span style="display: inline-block; width: 15px; height: 15px; background-color: #f4c400; border: 1px solid black; margin-right: 5px;"></span> 1 BED UNIT                  | <span style="display: inline-block; width: 15px; height: 15px; background-color: #cccccc; border: 1px solid black; margin-right: 5px;"></span> SERVICES  |
| <span style="display: inline-block; width: 15px; height: 15px; background-color: #e69d00; border: 1px solid black; margin-right: 5px;"></span> 2 BED UNIT                  | <span style="display: inline-block; width: 15px; height: 15px; background-color: #4a4a8a; border: 1px solid black; margin-right: 5px;"></span> LIFT      |
| <span style="display: inline-block; width: 15px; height: 15px; background-color: #c06000; border: 1px solid black; margin-right: 5px;"></span> 3 BED UNIT                  | <span style="display: inline-block; width: 15px; height: 15px; background-color: #4a7ebb; border: 1px solid black; margin-right: 5px;"></span> AMENITIES |
| <span style="display: inline-block; width: 15px; height: 15px; background-color: #4db6ff; border: 1px solid black; margin-right: 5px;"></span> LOBBIES, CORRIDORS & STAIRS | <span style="display: inline-block; width: 15px; height: 15px; background-color: #90d090; border: 1px solid black; margin-right: 5px;"></span> LANDSCAPE |

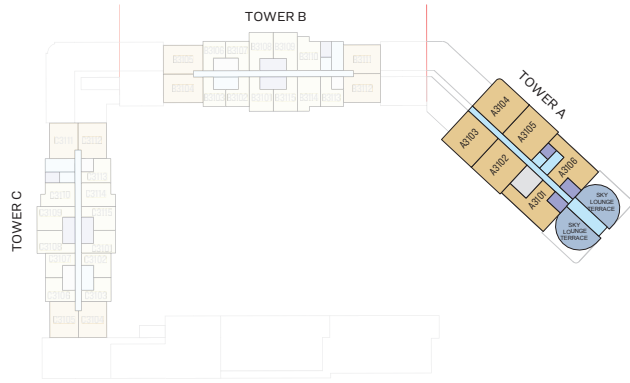
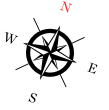

LEVEL 31

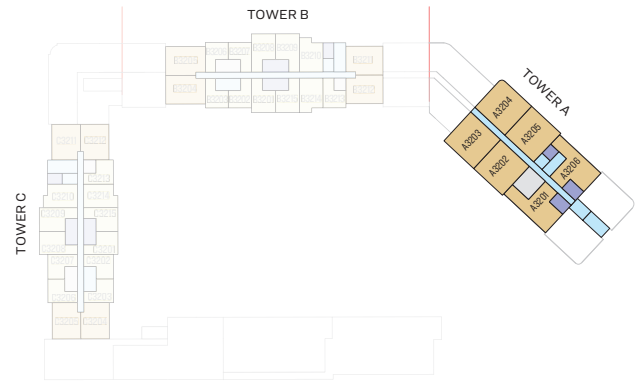

LEVEL 32

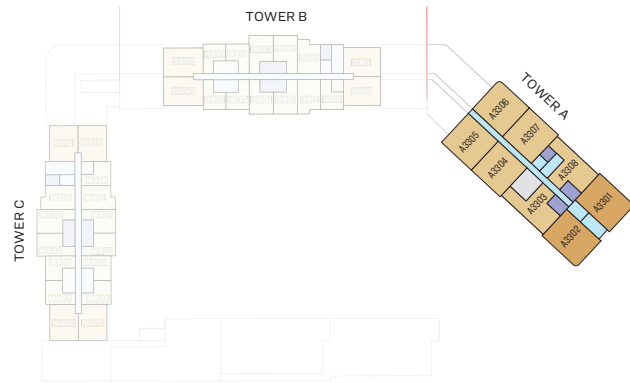

LEVEL 33

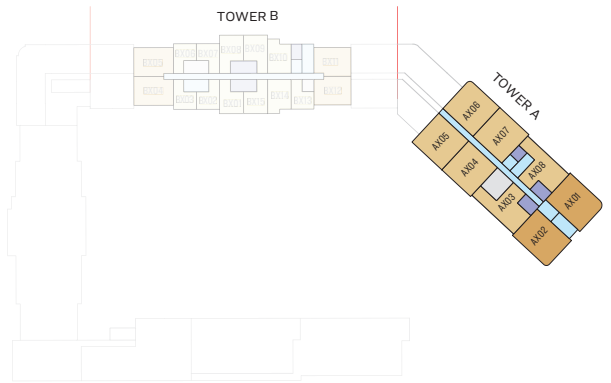

## RESIDENTIAL UNITS

# 1 BEDROOM APARTMENT

## TYPE A (with powder room + balcony)

### TOTAL SALEABLE AREA

SUITE = 528.83 SQ.FT.  
BALCONY = 44.24 SQ.FT.  
TOTAL = 573.07 SQ.FT.

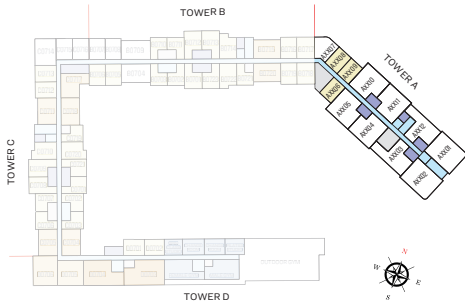

LEVEL 07-16 & 17-24

UNIT

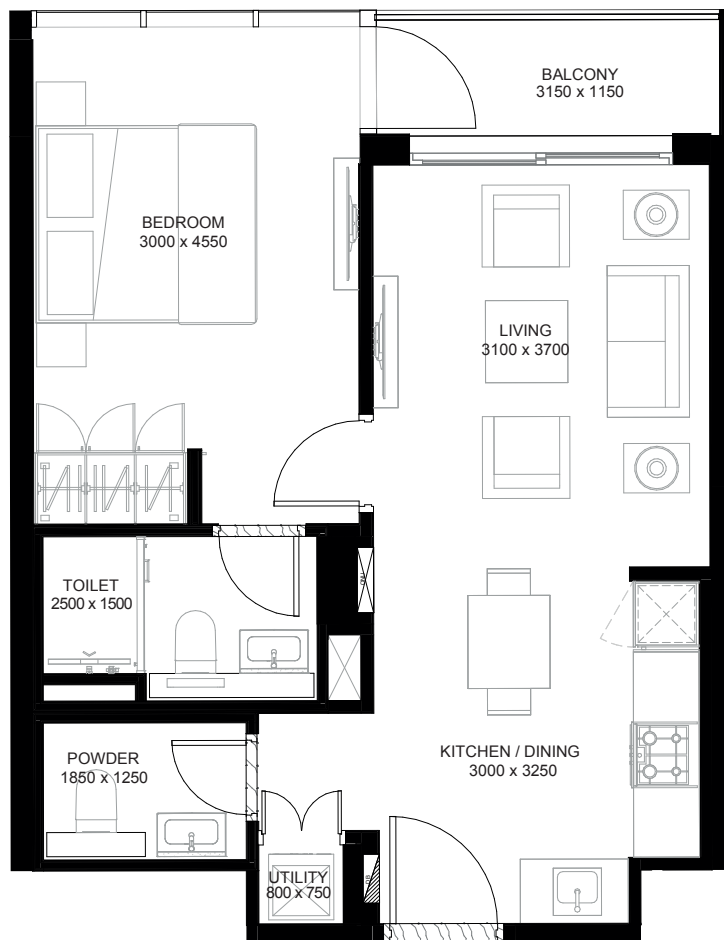

List of unit numbers with this unit plan:

### VIEWS

#### Amenities

A0706, A0806, A0906, A1006, A1106

#### Amenities, Waterfront

A1206, A1306, A1406, A1506, A1606, A1706, A1806, A1906, A2006, A2106, A2206, A2306, A2406

#### Downtown, Sports Court, Ras Al Khor

A0708\*, A0709\*, A0808\*, A0809\*, A0908\*, A0909\*, A1008\*, A1009\*, A1108\*, A1109\*, A1208\*, A1209\*, A1308\*, A1309\*, A1408\*, A1409\*, A1508\*, A1509\*, A1608\*, A1609\*

\* These apartments have mirrored units plans of the above

# 1 BEDROOM APARTMENT

TYPE A1 (with powder room + balcony)

## TOTAL SALEABLE AREA

SUITE = 568.73 SQ.FT.

BALCONY = 122.22 SQ.FT.

TOTAL = 690.96 SQ.FT.

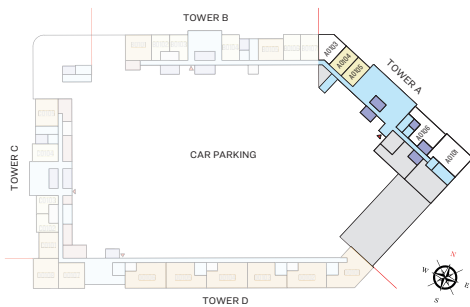

LEVEL 01(PODIUM 01)

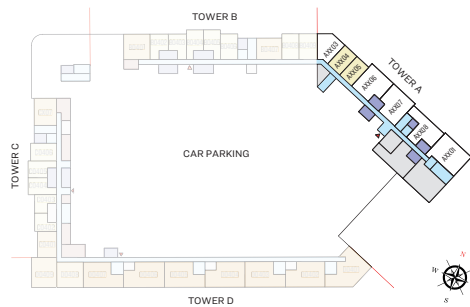

LEVEL 02-04

UNIT

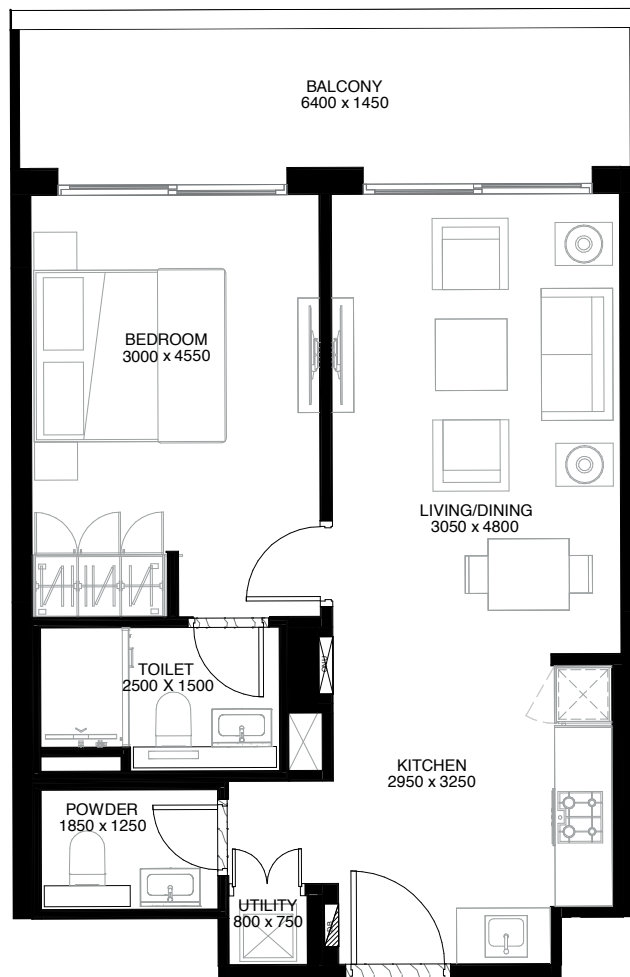

List of unit numbers with this unit plan:

## VIEWS

Sports Court  
A0104, A0105

Downtown, Sports Court  
A0204, A0205, A0304, A0305, A0404, A0405

\* These apartments have mirrored units plans of the above

# 1 BEDROOM APARTMENT

## TYPE C (with powder room + balcony)

### TOTAL SALEABLE AREA

SUITE = 634.75 SQ.FT.

BALCONY = 48.76 SQ.FT.

TOTAL = 683.51 SQ.FT.

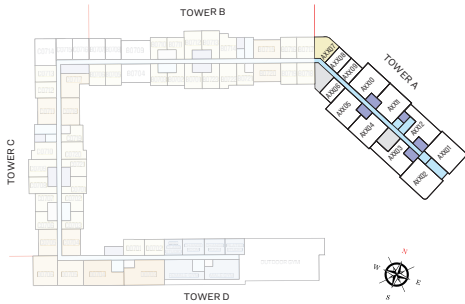

LEVEL 07-16

UNIT

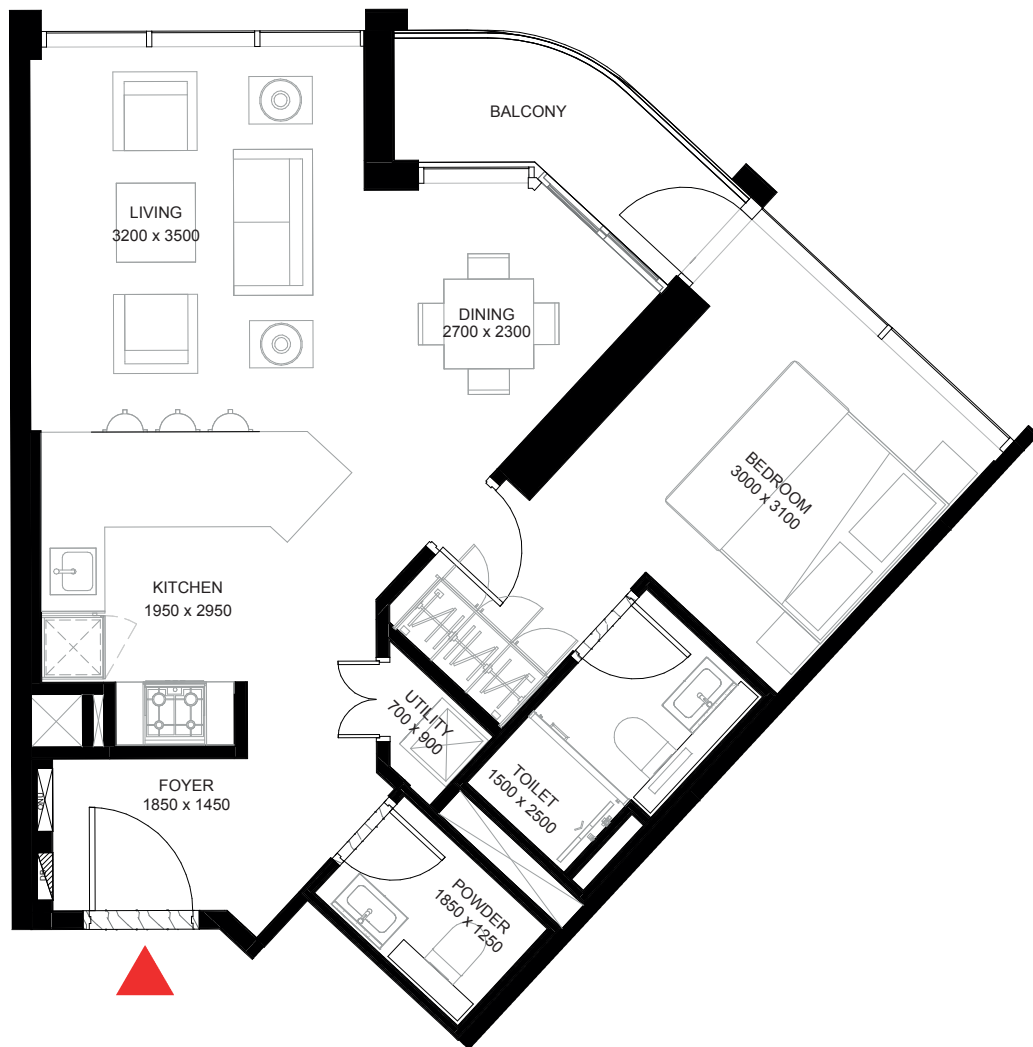

List of unit numbers with this unit plan:

### VIEWS

Downtown, Sports Court, Ras Al Khor

A0707, A0807, A0907, A1007, A1107, A1207, A1307, A1407, A1507, A1607

\* These apartments have mirrored units plans of the above

# 1 BEDROOM APARTMENT

## TYPE C1 (with powder room + balcony)

### TOTAL SALEABLE AREA

SUITE = 673.58 SQ.FT.  
 BALCONY = 215.86 SQ.FT.  
 TOTAL = 889.44 SQ.FT.

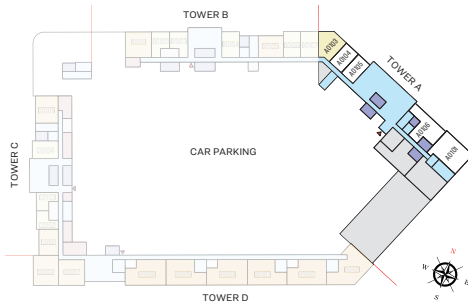

LEVEL 01

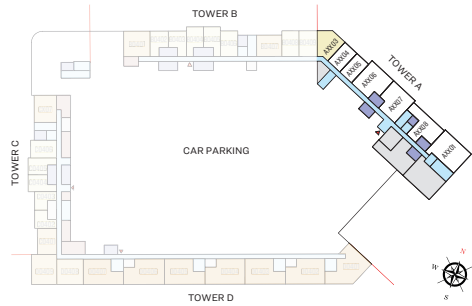

LEVEL 02-04

UNIT

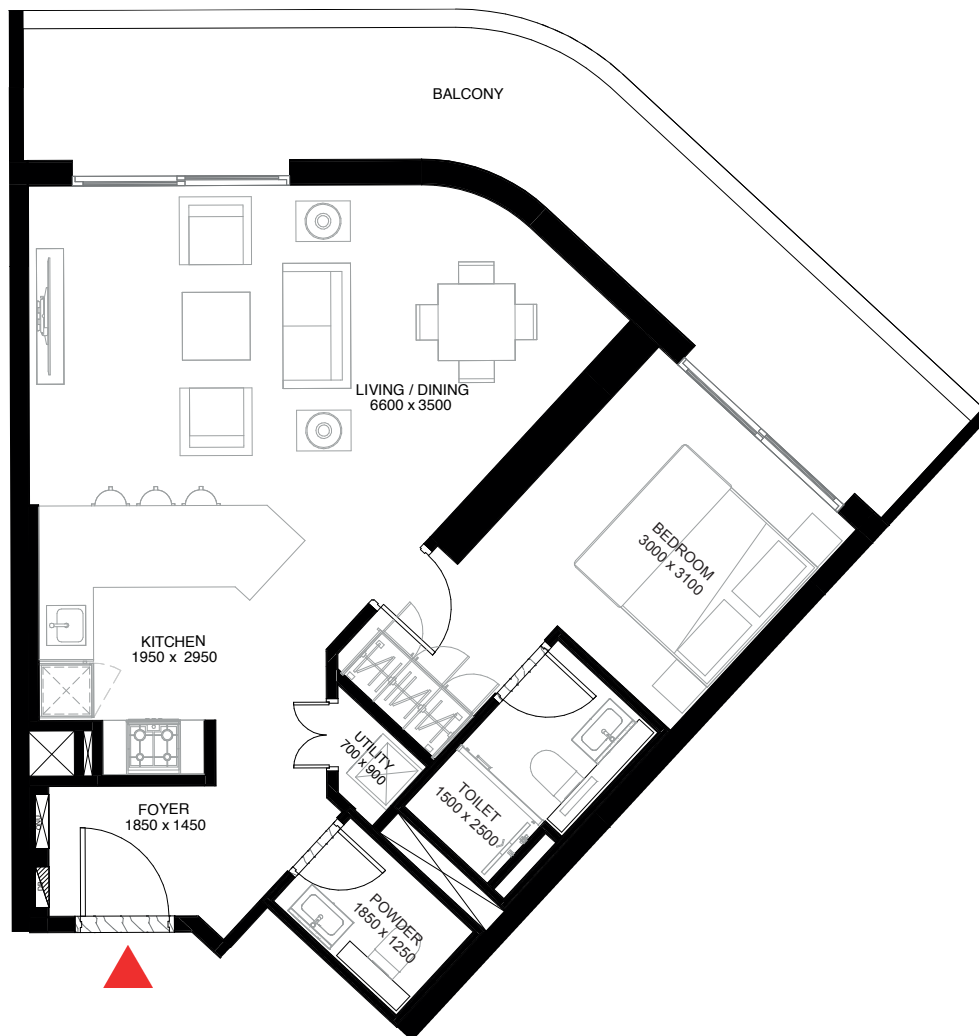

List of unit numbers with this unit plan:

### VIEWS

Sports Court  
 A0103

Downtown, Sports Court  
 A0203, A0303, A0403

\* These apartments have mirrored units plans of the above

# 2 BEDROOM APARTMENT TYPE C (with maid room + balcony)

## TOTAL SALEABLE AREA

SUITE = 1209.86 SQ.FT.

BALCONY = 60.82 SQ.FT.

TOTAL = 1270.68 SQ.FT.

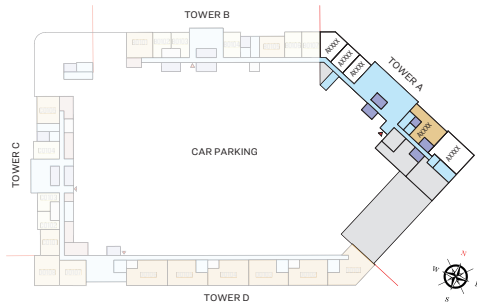

LEVEL 01-05

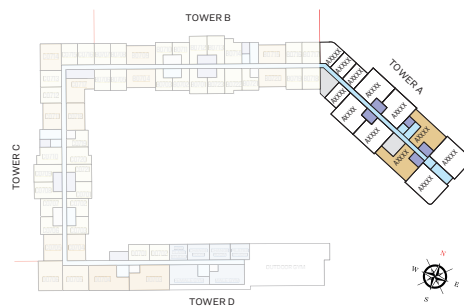

LEVEL 07-32

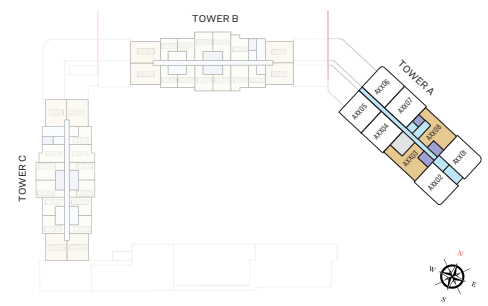

LEVEL 33-46

UNIT



List of unit numbers with this unit plan:

### VIEWS

Sports Court  
A0106\*

Downtown, Sports Court  
A0208\*, A0308\*, A0408\*, A0505\*

Downtown, Sports Court, Ras Al Khor  
A0712\*, A0812\*, A0912\*, A1012\*, A1112\*, A1212\*, A1312\*, A1412\*, A1512\*, A1612\*, A1709\*, A1809\*, A1909\*, A2009\*, A2109\*, A2209, A2309\*, A2409\*, A2508\*, A2604\*, A2704\*, A3106\*, A3206\*, A3308\*, A3408\*, A3508\*, A3608\*, A3708\*, A3808\*, A3908\*, A4008\*, A4108\*, A4208\*, A4308\*, A4408\*, A4508\*, A4608\*

### Amenities, Waterfront

A0703, A0803, A0903, A1003, A1103, A1203, A1303, A1403, A1503, A1603, A1703, A1803, A1903, A2003, A2103, A2203, A2303, A2403, A2503, A2603, A2703, A3101, A3201, A3303, A3403, A3503, A3603, A3703, A3803, A3903, A4003, A4103

### Amenities, Waterfront, Downtown

A4203, A4303, A4403, A4503, A4603

\* These apartments have mirrored units plans of the above



# 2 BEDROOM APARTMENT

TYPE D (with maid room + balcony)

## TOTAL SALEABLE AREA

SUITE = 1157.34 SQ.FT.

BALCONY = 114.85 SQ.FT.

TOTAL = 1272.19 SQ.FT.

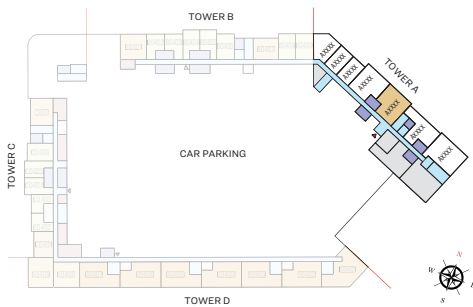

LEVEL 02-05

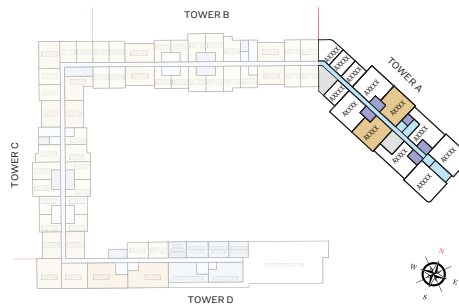

LEVEL 07-25

UNIT



List of unit numbers with this unit plan:

### VIEWS

#### Amentites

A0704, A0804, A0904

#### Amenities, Waterfront

A1004, A1104, A1204, A1304, A1404, A1504, A1604, A1704, A1804, A1904, A2004, A2104, A2204, A2304, A2404, A2504

#### Downtown, Sports Court

A0207\*, A0307\*, A0407\*, A0504\*

#### Downtown, BK, Sports Court, Ras Al Khor

A0711\*, A0811\*, A0911\*, A1011\*, A1111\*, A1211\*, A1311\*, A1411\*, A1511\*, A1611\*, A1708\*, A1808\*, A1908\*, A2008\*, A2108\*, A2208\*, A2308\*, A2408\*, A2507\*

\* These apartments have mirrored units plans of the above

# 2 BEDROOM APARTMENT

TYPE E (with maid room + balcony)

## TOTAL SALEABLE AREA

SUITE = 1170.36 SQ.FT.

BALCONY = 118.30 SQ.FT.

TOTAL = 1288.66 SQ.FT.

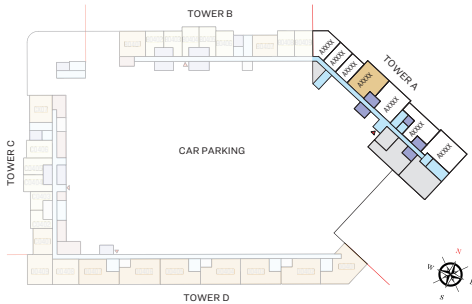

LEVEL 02-05

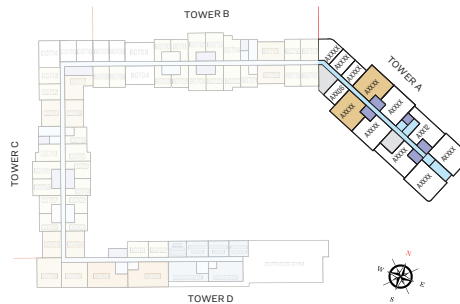

LEVEL 07-25

UNIT

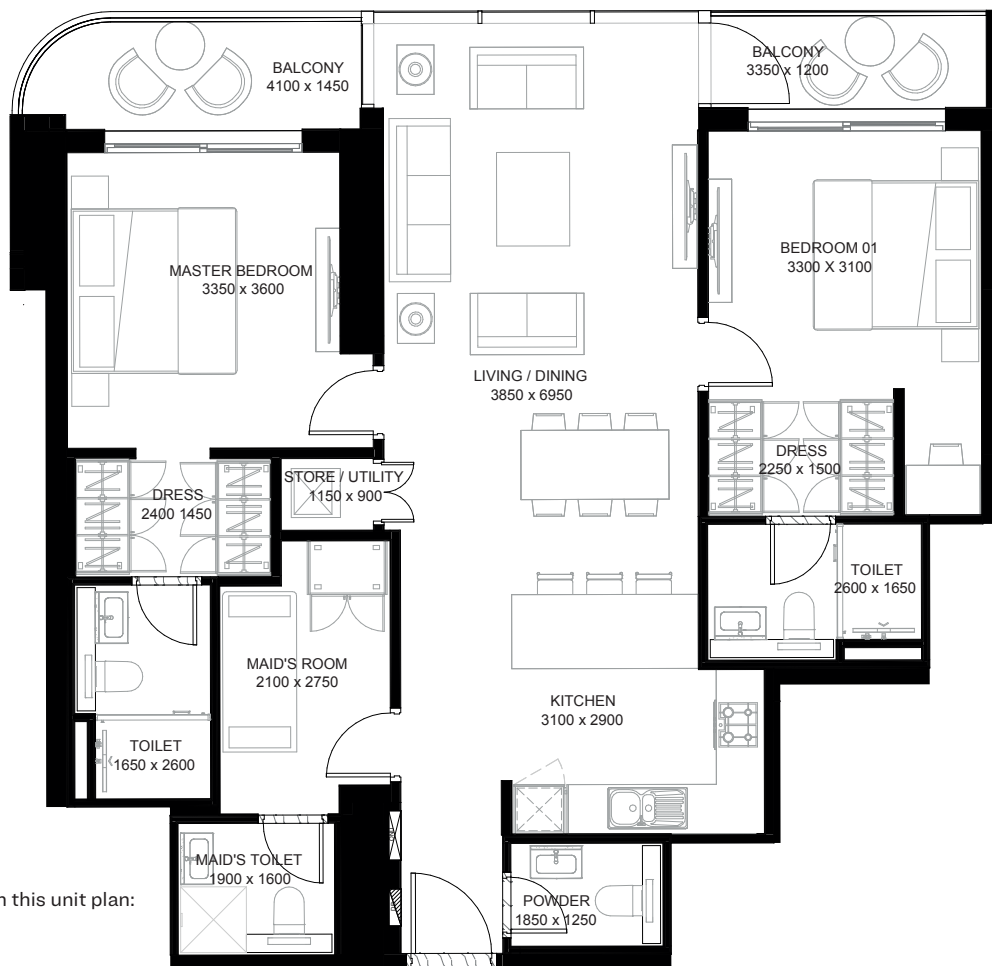

List of unit numbers with this unit plan:

### VIEWS

#### Amenities

A0705, A0805, A0905

#### Amenities, Waterfront

A1005, A1105, A1205, A1305, A1405, A1505, A1605, A1705, A1805, A1905, A2005, A2105, A2205, A2305, A2405, A2505

#### Downtown, Sports Court

A0206\*, A0306\*, A0406\*, A0503\*

#### Downtown, Sports Court, Ras Al Khor

A0710\*, A0810\*, A0910\*, A1010\*, A1110\*, A1210\*, A1310\*, A1410\*, A1510\*, A1610\*, A1707\*, A1807\*, A1907\*, A2007\*, A2107\*, A2207\*, A2307\*, A2407\*, A2506\*

\* These apartments have mirrored units plans of the above

# 2 BEDROOM APARTMENT

TYPE F (with maid room + balcony)

**TOTAL SALEABLE AREA**

SUITE = 1279.51 SQ.FT.

BALCONY = 114.74 SQ.FT.

TOTAL = 1394.25 SQ.FT.

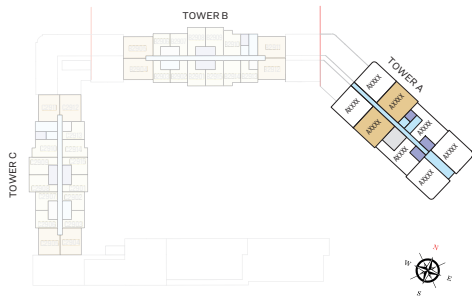

LEVEL 29-46

UNIT



List of unit numbers with this unit plan:

## VIEWS

### Amenities, Waterfront

A2901, A3001, A3102, A3202, A3304, A3404, A3504, A3604, A3704, A3804, A3904, A4004, A4104

### Amenities, Waterfront, Downtown

A4204, A4304, A4404, A4504, A4604

### Downtown, Sports Court, Ras Al Khor

A2904\*, A3004\*, A3105\*, A3205\*, A3307\*, A3407\*, A3507\*, A3607\*, A3707\*, A3807\*, A3907\*, A4007\*, A4107\*, A4207\*, A4307\*, A4407\*, A4507\*, A4607\*

\* These apartments have mirrored units plans of the above

# 2 BEDROOM APARTMENT

TYPE G (with maid room + balcony)

## TOTAL SALEABLE AREA

SUITE = 1270.25 SQ.FT.

BALCONY = 116.57 SQ.FT.

TOTAL = 1386.82 SQ.FT.

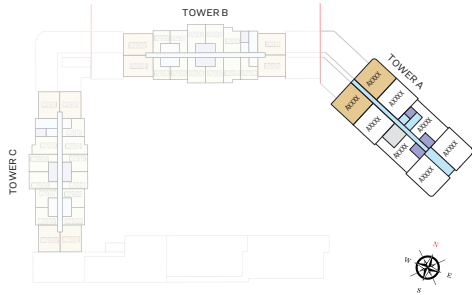

LEVEL 29-46

UNIT



List of unit numbers with this unit plan:

### VIEWS

Downtown, Sports Court, Ras Al Khor

A2903\*, A3003\*, A3104\*, A3204\*, A3306\*, A3406\*, A3506\*, A3606\*, A3706\*, A3806\*, A3906\*, A4006\*, A4106\*, A4206\*, A4306\*, A4406\*, A4506\*, A4606\*

Amenities, Waterfront, Downtown

A2902, A3002, A3103, A3203, A3305, A3405, A3505, A3605, A3705, A3805, A3905, A4005, A4105, A4205, A4305, A4405, A4505, A4605

\* These apartments have mirrored units plans of the above

# 3 BEDROOM APARTMENT

TYPE B (with maid room + balcony)

## TOTAL SALEABLE AREA

SUITE = 1497.15 SQ.FT.

BALCONY = 68.24 SQ.FT.

TOTAL = 1565.40 SQ.FT.

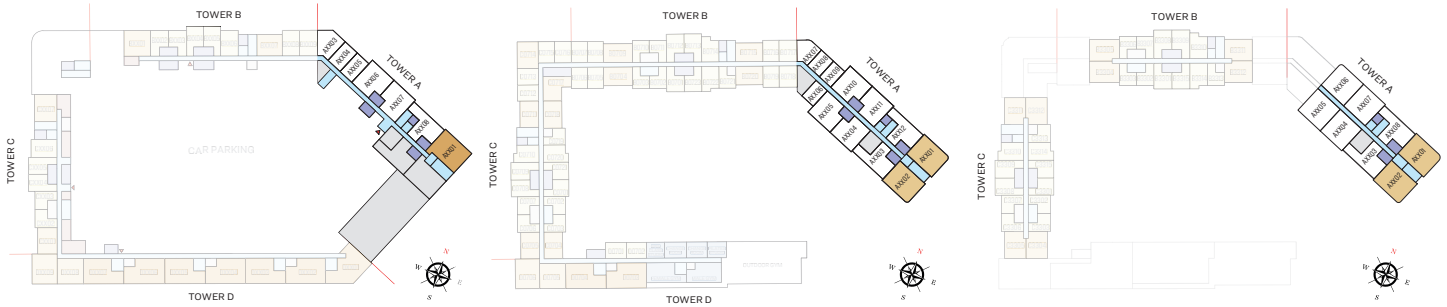

LEVEL 01-05

LEVEL 07-28

LEVEL 33-46

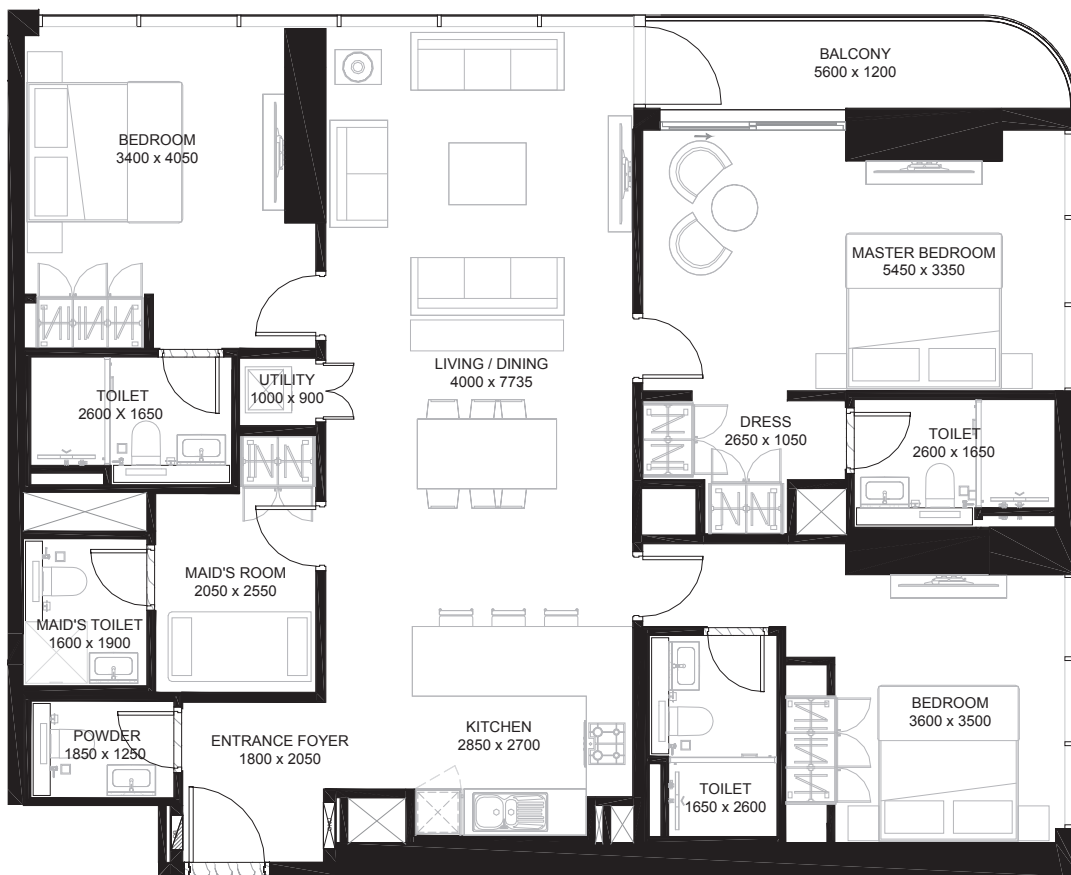

List of unit numbers with this unit plan:

### VIEWS

#### Amenities, Waterfront

A0702\*, A0802\*, A0902\*, A1002\*, A1102\*, A1202\*, A1302\*, A1402\*, A1502\*, A1602\*, A1702\*, A1802\*, A1902\*, A2002\*, A2102\*, A2202\*, A2302\*, A2402\*, A2502\*, A2602\*, A2702\*, A2802\*, A3302\*, A3402\*, A3502\*, A3602\*, A3702\*, A3802\*, A3902\*, A4002\*, A4102\*

#### Amenities, Waterfront, Downtown

A4202\*, A4302\*, A4402\*, A4502\*, A4602\*

#### Sports Court

A0101

#### Downtown, Sports Court

A0201, A0301, A0401, A0501

#### Downtown, Sports Court, Ras Al Khor

A0701, A0801, A0901, A1001, A1101, A1201, A1301, A1401, A1501, A1601, A1701, A1801, A1901, A2001, A2101, A2201, A2301, A2401, A2501, A2601, A2701, A2801, A3301, A3401, A3501, A3601, A3701, A3801, A3901, A4001, A4101, A4201, A4301, A4401, A4501, A4601

\* These apartments have mirrored units plans of the above

SOBHA  
REALTY